



35 New Trinity Road

East Finchley, London, N2 8EE

£725,000



Located on New Trinity Road, East Finchley is this stunning mid terraced freehold townhouse (1107 sq.ft / 103 sq.m) built in 2017. The property comprises of four bedrooms (three doubles and one single), two bathrooms and a modern open plan kitchen/reception room leading onto a private rear garden. The house has the added benefit of one off street parking space.

The property is located approximately 0.8 miles from East Finchley Underground Station (Northern Line) and 1.1 mile from Finchley Central Underground Station (Northern Line). There is also easy access to both the North Circular Road and the A1, with the cosmopolitan shops and restaurants of Muswell Hill, Finchley Central & East Finchley being within close proximity.



Floor Plans

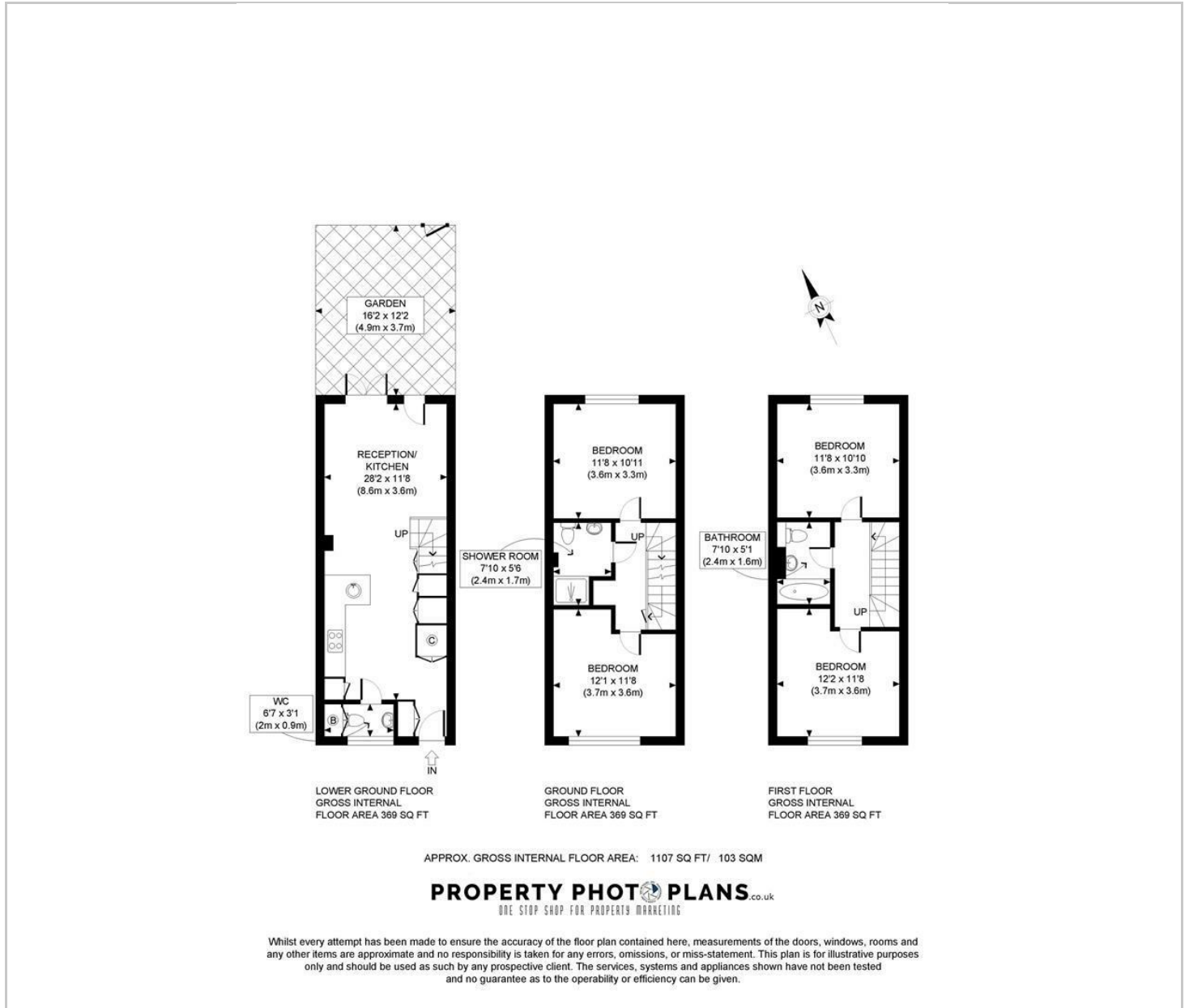

Area Map



Energy Efficiency Graph

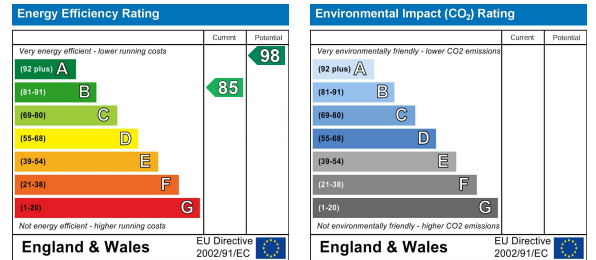

These particulars, whilst believed to be accurate are set out as a general outline only for guidance and do not constitute any part of an offer or contract. Intending purchasers should not rely on them as statements of representation of fact, but must satisfy themselves by inspection or otherwise as to their accuracy. No person in this firm's employment has the authority to make or give any representation or warranty in respect of the property.



118 Fortune Green Road • London NW6 1DH
 T. 020 7435 6066 • F. 020 7435 6366 • enquiries@livingresidential.com
 www.livingresidential.com

Living Residential Ltd., Reg No. 4759344 Reg Office: Summit House, 170 Finchley Road, London, NW3 6BP
 Registered in England and Wales